

TECMEN TM900

Lightweight Wide Vision Helmet for All-Day Welding Comfort

Welding requires precision and endurance, and the TM900 is built to deliver both. Featuring the same superior wide-lens visibility as the TM1000 but without the flip front, this helmet provides exceptional clarity while being lighter in weight—ideal for welders who want maximum comfort during long shifts.

Up to 30% lighter

than other welding helmets in its class with surround view



Why Choose the TM900?

For welders who spend long hours on the job, the TM900 offers superior wide-lens visibility in a lightweight design that reduces strain and fatigue. Its close fitting, fixed-front construction eliminates extra bulk, making it ideal for precision welding and overhead applications. Crystal-clear optics and an ergonomic fit keeps you focused and comfortable—so you can weld with precision, protection, and ease all day long.

Options:



TM900 with FreFlow
Code: WSHWR90002



TM900 for Freflow
Code: WSHWR90001



TM900 Helmet Only
Code: WSHWR90000

TM900

Lightweight, Best optical class
1/1/1/1 with true colour



Intelligent arc sensor technology

Not affected by natural/surrounding light,
stable outdoor performance.

Wide 107x75mm viewing area

Superior lens technology

Best optical class 1/1/1/1 to bring true
colour and clear vision to the welder.

- 1 Optical class: No distortion.
- 1 Light diff vision: No double vision.
- 1 Homogeneity: No shade variation.
- 1 Angle dependence: Shade remains
consistent when looking at any angle.

External grinding control

Allows quick switching from welding
to grinding and back without lifting the
welding hood or removing gloves.

Multi point adjustable headgear

Well balanced design,
maximum comfort level.

Side windows

Shade 5 lens on both sides,
enhances surround vision
for greater safety.

High impact resistance

Australian and New Zealand
Standard AS/NZS 1337.1 compliant.

World's best optical rating 1/1/1/1

- 1 Optical class: No distortion.
- 1 Light diff vision: No double vision.
- 1 Homogeneity: No shade variation.
- 1 Angle dependence: Shade remains consistent
when looking at any angle.

2 year lens warranty

Solar powered

with battery backup.
Automatic on-off so ready
to weld at any time.



True colour lens

Bringing realistic colour to
the welder's world. No more
green environments with
weak colour contrasts.

107x75mm

auto-darkening view
+ side windows

Easy lens controls

Weld shade adjustment 9-13.
Cutting shade adjustment 5-8.
Sensitivity adjustment 1-10.
Delay adjustment 1-10.

TM900 FreFlow PAPR

All the great benefits with the powered air-purifying respirator.



TM900 Specifications, Parts & Accessories



TM900 Welding Helmet Specifications

Optical Class	1/1/1/1
Viewing Area	107 x 75 mm
Cartridge Size	156 x 123 x 33 mm
Arc Sensor	4
Light State	DIN 3
Dark State	DIN 5-8/9-13
Shade Control	Internal, Digital Display Control
Sensitivity Control	Low-High, Digital Display Control
On/Off	Auto On/Off
Power Supply	Solar cell, Battery replaceable
Battery Type	2 x CR2450
Switch Time	1/25,000 s. from Light to Dark
Delay Time (Dark to Light)	0.1 ~ 1.0 s, Digital Display Control
Low TIG Amps Rated	≥ 2 amps (DC); ≥ 2 amps (AC)
Grind Mode	External grinding control
Low Battery Indicator	Digital Display
Battery Capacity Test	Digital Display
Helmet Weight	Standard helmet 730g. Respiratory version 890g.
Helmet Material	High-impact Resistance Nylon
Operating Temperature	10°C ~ +55°C (14°F ~ 131°F)
Application Range	Stick Welding (DC&AC). TIG(DC,DC Pulse);TIG AC(Pulse),Excellent low amperage TIG response. MIG/MAG ;MIG/MAG Pulse;Plasma Cutting/ Welding. Grinding. Oxyacetylene Welding/Cutting.
Warranty	Auto darkening lens: 2 years
Standards	Helmet: AS/NZS1337.1:2010 High impact rated Lens: AS/NZS1338, EN379
FreFlow connection	Quick connect hose

Spare Parts

Item	Qty	Code
1 Front lens holder	1	WSHWR95007
2 Outside cover lens	1	WSHWR95003
3 Auto darkening filter (ADF950S)	1	WSHWR95012
4 950S Inside cover lens	1	WSHWR95004
5 Grind lens holder	1	WSHWR95008
6 Grind lens (anti-fog)	1	WSHWR95005
7 Helmet shell (non-air)	1	WSHWR90017
7 Helmet shell with airflow	1	WSHWR90018
8 Side lens cover	1	WSHWR95013
9 Face seal	1	WSHWR95016
10 Headgear (non-air)	1	WSHWR95014
10 Headgear for air	1	WSHWR95015
11 12 Sweatbands	1	WSHWR95006

Optional

Item	Qty	Code
13 Front Leather Throat Protection	1	WSHWR95040
14 Back Hood Cover Protection	1	WSHWR95041

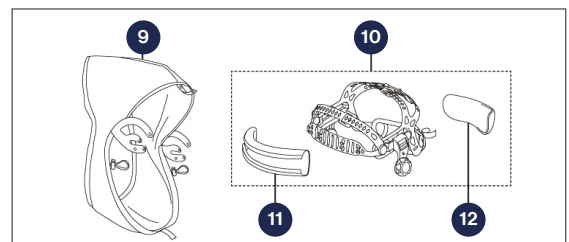
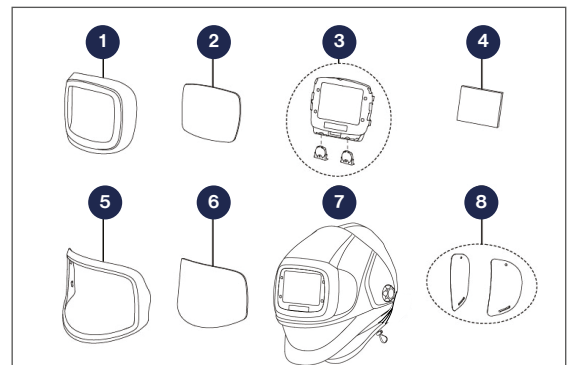

13 Front Leather Throat Protection

- Added leather throat protection for TECMEN welding helmets.
- Protects your neck and upper chest/shoulders from molten metal, sparks and flames.

14 Back Hood Cover Protection

- Extra back of head and neck protection to fit your TECMEN welding helmet and respirator.
- To protect you from molten metal, sparks and flames while you weld.
 - Flame resistant material.